

## PE-X Shrink Sleeve for shrinkable PE or PE-X Joint Casing

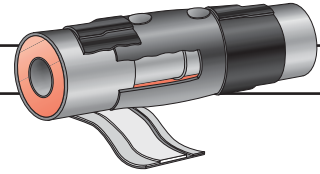

All dimensions are in mm

### Sleeve cut length

ØD	L
90-200 mm	M* + 75 mm
225-500 mm	M* + 100 mm
≥ 560 mm	M* + 125 mm

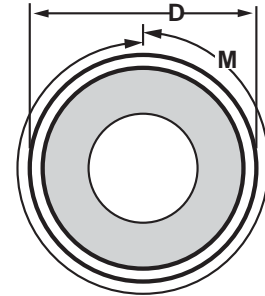

M\*: Circumferential length of shrinkable PE or PE-X Joint Casing in the sealing zone after application.

Recommended application	Closure Patch width 100 mm
Possible application	Closure Patch width 150 mm

*Below selection table applies only when in combination with Shrinkable Joint Casings (not when in combination with Oversized Casings)*

Jacket Pipe Ø	90	110	125	140	160	180	200	225	250	280	315	355																
RJS-E/A																												
width	155																											
	230																											
Jacket Pipe Ø	90	110	125	140	160	180	200	225	250	280	315	355	400	450	500	560												
RJS-E/B																												
width	230																											
Jacket Pipe Ø													160	180	200	225	250	280	315	355	400	450	500	560	630	670	710	800
RJS-E/C																												
width													300															

Contact your local Berry Plastics Sales representative for other or special applications.