

There are 2 types of application:

- as end seal
- as jacket pipe continuation

End Seal

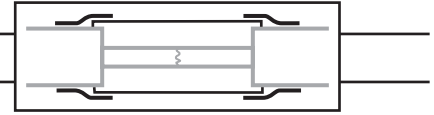

Sleeve cut length

Jacket pipe Ø	Sleeve length	Patch width
≤ 200	75 mm + circumference of casing	100 mm
225 - 500	100 mm + circumference of casing	100 mm
≥ 500	125 mm + circumference of casing	150 mm

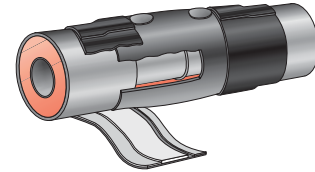

Sleeve width depending on jacket pipe diameter

- Recommended application
- Possible application

1. In combination with SHRINKABLE CASING (no gap)

Jacket Pipe Ø	90	110	125	140	160	180	200	225	250	280	315	355	400	450	500	560	630	670	710	800	900	1000	1200	
190	■	■	■	■	■	■	■	■	■	■	■	■	■	■	■	■	■	■	■	■	■	■	■	■
Sleeve width 255	■	■	■	■	■	■	■	■	■	■	■	■	■	■	■	■	■	■	■	■	■	■	■	■
Sleeve width 320	■	■	■	■	■	■	■	■	■	■	■	■	■	■	■	■	■	■	■	■	■	■	■	■

2. In combination with NON SHRINKABLE CASING (gap)

Jacket Pipe Ø	90	110	125	140	160	180	200	225	250	280	315	355	400	450	500	560	630	670	710	800	900	1000	1200
190	■	■	■	■	■	■	■	■	■	■	■	■	■	■	■	■	■	■	■	■	■	■	■
255	■	■	■	■	■	■	■	■	■	■	■	■	■	■	■	■	■	■	■	■	■	■	■
Sleeve width 320	■	■	■	■	■	■	■	■	■	■	■	■	■	■	■	■	■	■	■	■	■	■	■
Sleeve width 430	■	■	■	■	■	■	■	■	■	■	■	■	■	■	■	■	■	■	■	■	■	■	■

Note: gap = distance in between top of PE jacket pipe and, inside of oversized casing when fully lifted. Maximum gap is 3,5 times oversized casing thickness. Casing must be bevelled.

Jacket pipe continuation

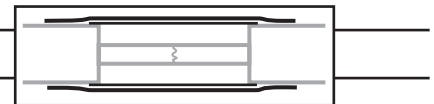

Sleeve cut length

Jacket pipe Ø	Sleeve length	Patch width
≤ 200	75 mm + circumference of casing	100 mm
225 - 500	100 mm + circumference of casing	150 mm
≥ 500	125 mm + circumference of casing	150 mm

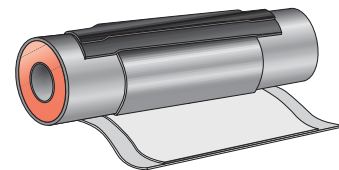

Sleeve width depending on length of the metal sheet casing or on the length of half-shells

Half-shells or casing length to cover	Sleeve width
between 237 and 391 mm	640 mm + S1113 mastic strip at stepdown or pipe edges
between 392 and 434 mm	640 mm
between 435 and 523 mm	770 mm + S1113 mastic strip at stepdown or pipe edges
between 524 and 566 mm	770 mm
between 567 and 655 mm	900 mm + S1113 mastic strip at stepdown or pipe edges
between 656 and 698 mm	900 mm

Note: a strip of S1113 mastic must be centred over the end of the metal sheet casing or the half-shell. (50 mm width, 1 mm thick)